



VIEW FROM STABLE ROAD INTO THE PROPERTY  
(Fence is unstained in above photo)



VIEW FROM REAR YARD TO PROPERTY TO EAST  
(Fence shown stained desired grey color in photo above)



VIENS OF NORTH SIDE YARD FROM STABLE ROAD



EXISTING SCREENING OF WESTERN NEIGHBOR BEHIND APPROXIMATE LOCATION OF PROPANE TANK PAD



ILLUSTRATION OF PROPOSED GATE AND PLANTING Fence painted gray. Gate to match color of front door. House trim to be painted gray to match fence

WILDFLOWER MEADOW SEEDING NOTES

- Herbicide based approach:
- Eight weeks before seeding, eradicate existing vegetation by having a licensed spray applicator apply an approved herbicide. Please note this is a two-time application whereas many farms continually use herbicide for weed control while growing food crops.
  - Two weeks after herbicide application, mow treated growth to a height of 4-6". This will prevent surviving plants from going to seed and allow time for weed seeds to germinate. Do not mow sooner than 2 weeks after herbicide application to allow time for herbicide to get into roots of plants.
  - Two weeks prior to seeding, have the licensed spray applicator apply a second non-selective herbicide application.
  - Two to three days before seeding, scalp mow dead material. Inspect site to ensure that no further herbicide treatments are necessary. If growth is completely dead, mow area as low as possible (1-2"). Rake off excess plant refuse but leave dead roots and crowns to stabilize soil prior to seed germination. Approximately 50% of the soil surface should be visible in any one area.
- Non-herbicide based approach:
- Smother weeds with black plastic instead of spraying herbicide. Follow all the same steps but instead of using herbicide, use black plastic to smother weeds. It will take much longer to smother weeds as it will take for weeds to die. Timing depends on how hot and dry it is. Weeds must be completely smothered for this technique to work.
- Seeding, no till - hand seeding:
- Scarify soil to a depth of 1/2". Repeat as needed to create seedbed with approximately fifty percent of the soil exposed. Tilling is not recommended as it encourages the germination of dormant weed seeds.
  - Segregate seeds according to mix and size.
  - Inoculate leguminous seeds.
  - Bulk up large seed by mixing the seed with an inert bulking material such as saw dust, kitty litter, or vermiculite.
  - Hand broadcast the large seed mix evenly over the surface. Use a pattern and method of dispersal that reduces the chances of using up the mix prematurely. Subdividing and marking the area into sections can facilitate the process.
  - Rake seed lightly into the soil to a depth of approximately 1/4" using appropriate equipment.
  - Bulk up the very fine seed in the manner described above and broadcast this mix over the surface. Do not incorporate into soil as these species require light to germinate and will not do so if buried in the soil.
  - Tamp seed for proper seed-to-soil contact with roller, drag, or another appropriate tool
  - Mulching the planting is usually not required as the remaining dead stubble and plant refuse will perform this function. If there is not sufficient mulch from these sources, spread a thin layer of weed-free straw such as salt marsh hay or winter wheat straw. Mulch should leave approximately fifty percent of the soil exposed to sunlight.
  - Watering is not required. If no rain falls for an extended period after planting and if a source of water is readily available, apply up to 1" of water per week (including rainfall) for a period of six weeks to facilitate meadow establishment.

PLANTING NOTES

1. Soil: Install 6" topsoil compost mix. Scarify or dig all proposed planting areas to a depth of 12"-24" or as determined by Landscape Architect.
2. Topsoil-compost mix shall consist of 85%-90% stockpiled topsoil (if available) and 10%-15% well-rotted compost. Topsoil shall be natural, friable, fertile soil, characteristic of productive soil in the vicinity, reasonably free from stones, clay lumps, roots and other foreign matter, with an acidity level between 5.5 and 7 pH. If stockpiled topsoil is not available, use purchased topsoil in sufficient quantity to complete the requirements as specified. Purchased soil shall meet the following particle size distributions: less than or equal to 15% of gravel (particle size greater than 2.00 mm), 40%-60% of sand (0.05-2 mm), 30%-40% of silt (0.002-0.05 mm), and 10%-20% clay (<0.002mm) and 10-15% well-rotted compost with an acidity level between 5.5 and 7.0 pH. Percentages are by weight. Topsoil and purchased soil shall be subject to approval by Landscape Architect.
3. All plants shall meet or exceed the latest edition of American Standard for Nursery Stock by the American Association of Nurserymen, ANSI Z60.1.
4. Warranty: All plants shall be warranted for a period of one year. Replace, in accordance with the drawings and specifications, all plants that are missing, more than 25% dead, do not develop from planting stock, that appear unhealthy or unsightly and/or that have lost their natural shape due to dead branches. Any tree that loses its main leader shall be replaced. Provide guarantee for all replacement plants for at least one full growing season.
5. Watering: Watering of plants and areas of ground covers such as lawns shall be contractor's responsibility until final acceptance of completed project by Owner. Watering responsibility after acceptance shall be clearly stated in Contractor's bid. If not stated in Contractor's bid, the Contractor shall be responsible for watering if and as necessary.
6. Substitutions: There shall be no substitution of plant materials without the written consent from Landscape Architect.
7. Nomenclature Tags: Contractor shall not remove nomenclature tags from plants until receipt of written inspection report by Landscape Architect.
8. Shrub size: Shrubs shall meet the requirements for height indicated on the Plant List. The measurements for height shall be taken from the ground level to the average height of the top branches of the plant and not to the longest branch. Single stemmed or thin plants will not be accepted. Side branches shall be generous and well twigged. Plants shall be in a moist, vigorous condition, free from dead wood, bruises or other root or branch injuries.
9. Plant quantities: Contractor shall be responsible for counting plant material on drawing. If a discrepancy exists between the plant count shown on the Plant List and the Planting Plan, the Planting Plan count shall take precedence.
10. Underground utilities: The contractor is hereby notified that underground utilities exist and the contractor shall obtain current utility record maps and notify all utility companies prior to commencing work. Utility location shall be verified in the field with the general contractor prior to commencement of any digging operations. In the event that any underground utility is uncovered, the owner/general contractor/utility company shall be notified.
11. Tree staking: Stake trees immediately after planting. Stakes are to be removed by the contractor at the end of the guarantee period.
12. Landscape Contractors: Landscape materials shall be installed by local companies familiar with the conditions in this area that employ NYS Certified Nursery Professionals or with an owner or foreman that has a degree in horticulture, arboriculture, botany, or any other landscape degree or qualified experience.
13. Perimeter Area protection: The contractor shall not disturb any area outside the work area as indicated on the Grading Plan. Storage of materials or equipment is not permitted within areas delineated as do not disturb.
14. Erosion Control: The contractor shall follow regulations for topsoil storage and soil stabilization in accordance with local or state erosion control regulations.
15. This drawing shall be used for landscaping purposes only.
16. During planting operations, if wet soils are encountered, plants may be set up to three inches above surrounding grade.
17. Plants shall be pruned at the time of planting, if necessary, in accordance with standards set forth by the International Society of Arboriculture.
18. All street and shade trees planted near pedestrian or vehicular access shall limbed up to 8'. All street and shade trees within intersection sight triangles shall be limbed up to 10'.
19. All plant material shall be planted with the same relationship of finish grade as at the nursery.
20. All shrub and perennial masses shall be planted in continuous beds.
21. Plants shall be planted during the following growing seasons: With irrigation or a comprehensive watering schedule in place, upon completion of construction, from March 1-November 15 for evergreens, March 1-December 15 for deciduous trees. Without irrigation or a comprehensive watering schedule, do not plant June 15-August 15.
22. Seeding schedule: Seed indicated areas between April 1-May 31, August 15-October 15.
23. Seeded area preparation: Install 6" minimum topsoil in accordance with topsoil requirements in note #1 above. Rock rake to remove stones larger than 1/2". Seeded area preparation per 1000 square feet: Install 40 lbs hay mulch, 15 lbs 5-10-5 fertilizer, 50% slow release. Install limestone as needed in accordance with pH soil test. Seed mixture: Pearl's Premium Shade Tolerant grass seed.
24. All debris resulting from landscape work shall be removed from site after planting is complete. Property shall be left in a neat and orderly condition.
25. Existing landscape beds: Weed and install 3" bark mulch in existing landscape beds and 6" rings (minimum) around existing trees to remain. Where lawn meets garden beds, dig trench 6" deep to separate landscape beds from lawn areas.

APPROXIMATE LOCATION AND SIZE OF PROPOSED PAD

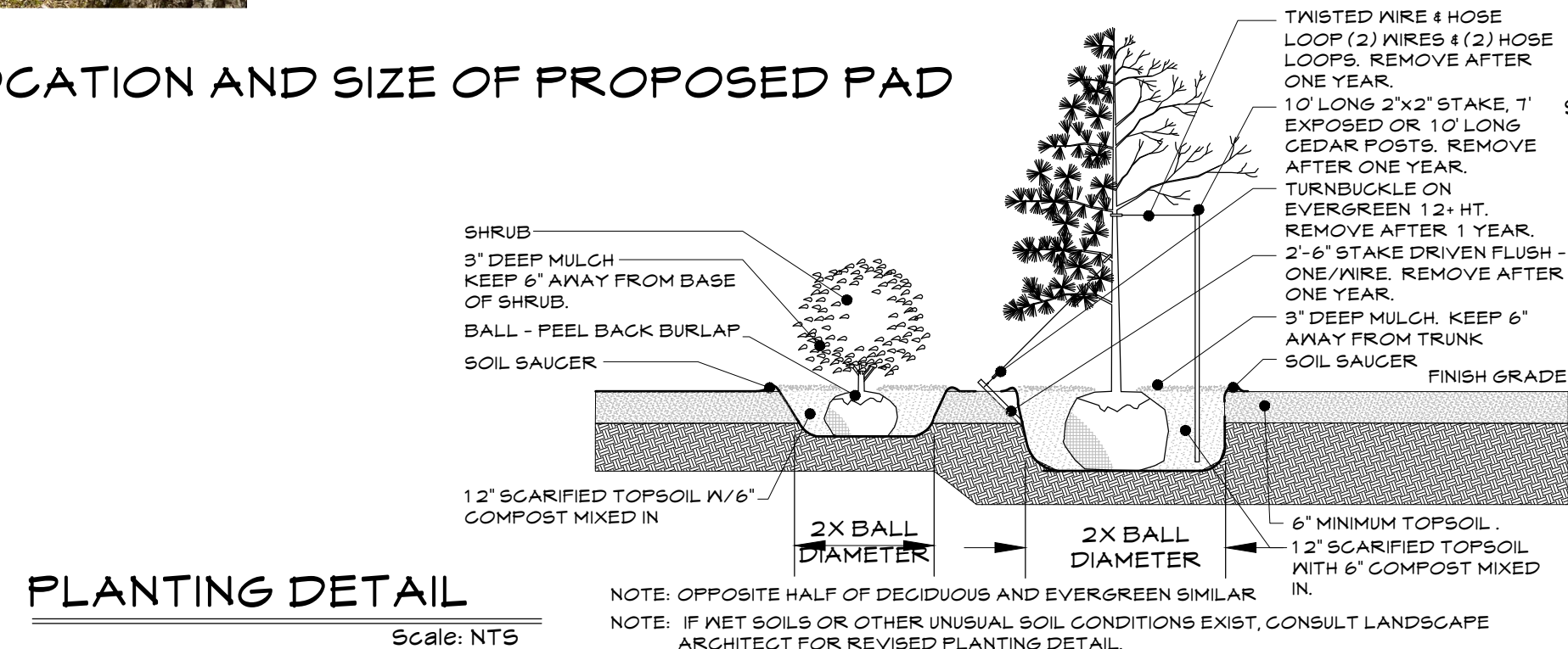

Submittal Date: January 30, 2023			<b>THE MALLOY RESIDENCE</b> 2 STABLE ROAD TUXEDO PARK, NEW YORK		
<b>REVISIONS</b>					
No.	Date	Description	Per BAR	<b>SITE PHOTOS AND PLANTING NOTES</b>   <b>KAREN ARENT LANDSCAPE ARCHITECT</b> 12 OLD MINSINK TRAIL • GOSHEN, NEW YORK 10924 845 294 9588 phone • 845 294 6545 fax	New York License #  Unauthorized alteration or addition to this drawing is a violation of Section 7209 (2) of the New York State Education Law
1	2/21/23				

Drawn By: KA    Checked By: XX    Seal: AS NOTED

**L2**    2 of 2